

MODULO H13 Technical sheet

1. DESCRIPTION

Modular formwork made of recycled PP for ventilated foundations and for the creation of a physical barrier between the ground and the building.



2. TECHNICAL SPECIFICATIONS

Material	-	Recycled polypropylene (PP) 80-90%
	-	Minerals 0-10%
	-	Recycled polyethylene (PE) 10%
Percentage of recycled material	%	100
Color	-	Black
Dimensions*	cm	50x50x H13
Weight	kg	1.01 (± 10%)
Concrete consumption flush to the formwork**	m ³ /m ²	0.028
Installations passage	mm	1x Ø70mm / 2x Ø50mm
Supporting surface of the pillar	cm ²	187.69
No. of pillars per m2	-	4
Installation time	m ² /h/worker	90
Place of production	-	Italy

* in consideration of the recycled material, the measures should be evaluated with a tolerance of ± 1,5%

** The volume is subject to changes depending on the casting conditions and material tolerances

3. LOAD CHART

LOAD (Kg/m ²)	Slab THICKNESS (cm)	REINFORCEMENT (mm)	Lean concrete thickness (cm)	Gravel thickness (cm)	Ground pressure (Kg/cm ²)
500	5	Ø5 / 25x25	5		0,29
1,000	5	Ø6 / 20x20	5		0,58
2,500	5	Ø8 / 20x20	10		0,72
5,000	7	Ø8 / 20x20	5	10	0,90
10,000	6	Ø10 / 20x20	5	15	1,10
>10,000	To be assessed on a case-by-case basis by consulting the Geoplast Technical Office				

* It is the designer's responsibility to assess that the installation plan is able to guarantee the specified pressures.

4. TECHNICAL DRAWINGS

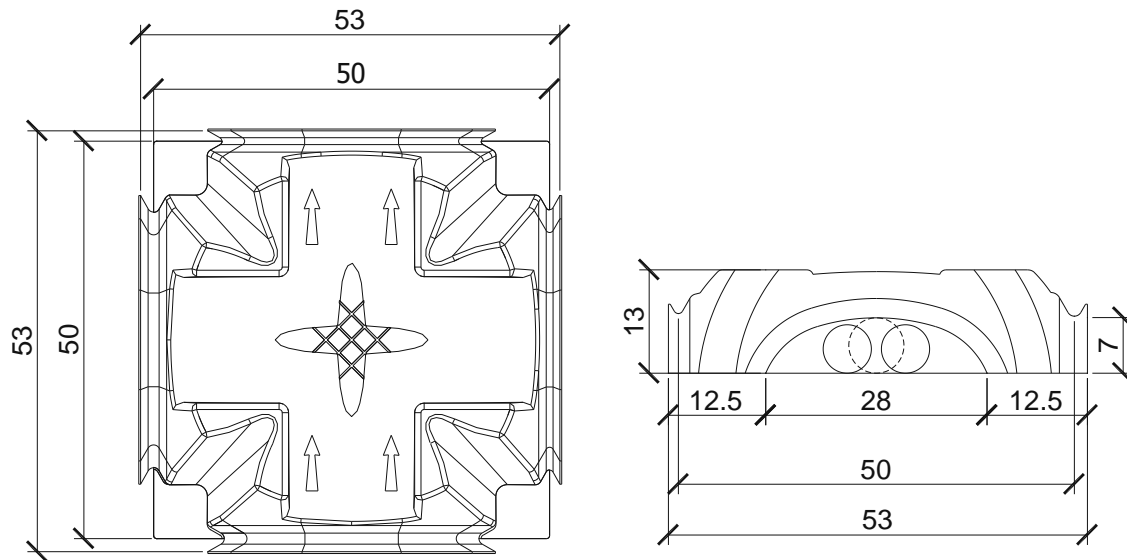

5. PACKAGING AND TRANSPORT

Product code	-	EMODULO5013
Packing Size	cm	102 x 102 x H235
Type of packaging	-	Stacked and wrapped in plastic film
Quantity per pallet	pcs	360
Surface area per pallet	m ²	90
Package gross weight	kg	365

6. INSTALLATION METHOD

The Modulo installation is carried out by placing the formwork from right to left and from top to bottom, always keeping the arrow printed upwards. It is essential to check the correct fitting of the feet.

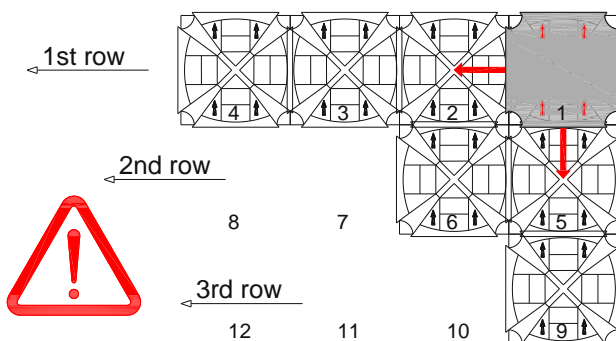

Before starting to install the elements, we recommend that you consult Geoplast® project tables to position the elements appropriately. For a correct installation, in compliance with safety regulations, please refer to the installation manual.

GEOBLOCK H13 Technical sheet

1. DESCRIPTION

Adjustable extension for the Modulo formwork for the realization of ventilated crawl spaces and foundation beams in a single casting.



2. REFERENCE DIMENSIONS

Height (H)	cm	8.1
Net width (ai)	cm	30.2
Net length (li)	cm	30.3
Width (ae)	cm	36.6
Length (le)	cm	34.5
Step	cm	3.5
Maximum extension	cm	25
Weight	kg	0.45

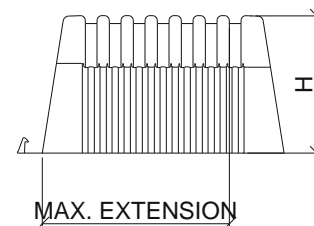
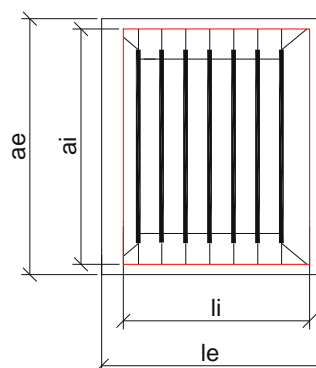

3. PACKAGING AND TRANSPORT

Product code	-	EMOGBLO0013
Packing Size	cm	110 x 110 x H180
Type of packaging	-	Stacked in pallets
Quantity per pallet	pcs	500
Pallet weight	kg	240

FERMAGETTO H13 Technical sheet

1. DESCRIPTION

Side closure for Modulo formwork for the realization of ventilated under-floor cavity and foundation beams in a single casting.



2. PACKAGING AND TRANSPORT

Product code	-	EMOFGET0013
Packing Size	cm	80 x 120 x H100
Type of packaging	-	Stacked in pallets
Quantity per pallet	pcs	500
Weight	kg	0.09
Pallet weight	kg	60